

AURA V2.5

Priority for Indoor Commercial Display

Product features:

❖ Self-developed cabinet:

Unique exterior design, there are anti-dorking hole positions on the left and right, and the bottom has a bump-proof raised design.

❖ High precision

Cabinet CNC machining size tolerance $\pm 0.05\text{mm}$ can be seamless splicing, flatness $\leq 0.2\text{mm}$.

❖ High Brightness ,High Contrast, High Refresh

Standard brightness $\geq 600\text{nit}$, refresh rate up to 5000:1, Standard 3840Hz.

❖ Good Compatibility

Replace the indoor P1.2~P4 module with the same series.

❖ Efficient Installation,Front Maintenance

❖ Support 45° cut angle, 90° splicing programmatic *

❖ Supports dual backup of power and signal*

❖ Support XYZ six adjustments*

❖ Support cut half cabinet program (320*480mm)*

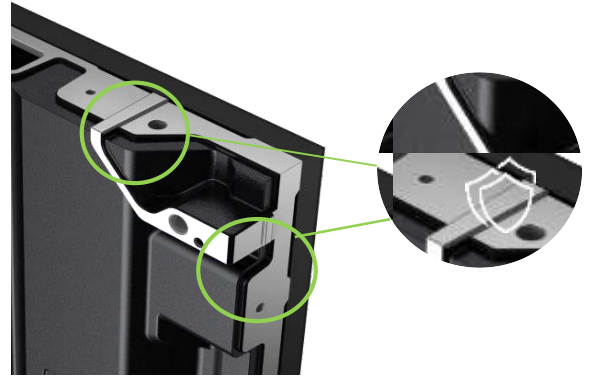

Thickness: 44.9mm
Weight: 3kg

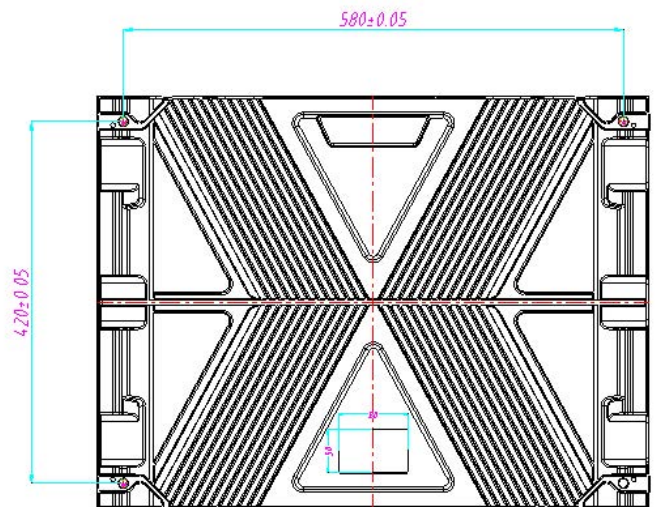
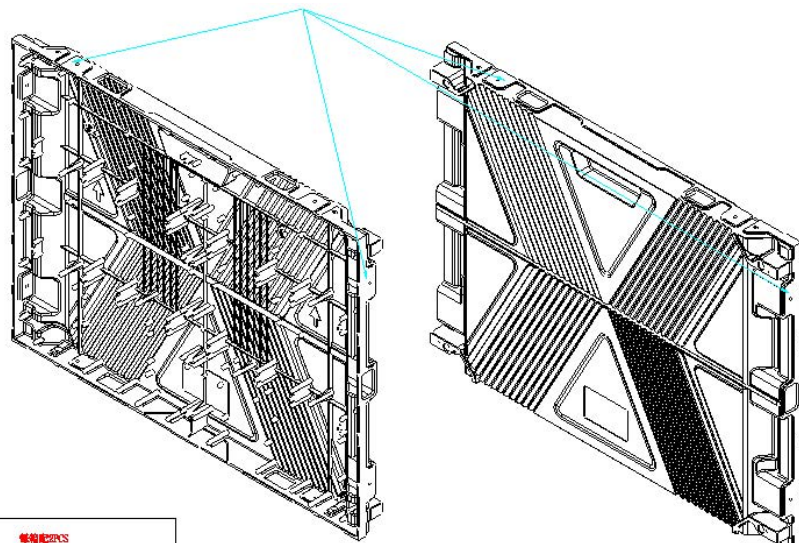

SPECIFICATION PARAMETERS:

| | Parameter | Value |
|-------------|-----------------------------------|--|
| Module | Pixel Pitch | 2.5mm |
| | LED Type | SMD2121 |
| | Module Resolution (W×H) | 128X64=8192 Pixels |
| | Pixel density (pixels/sq.m.) | 160000 dot/m ² |
| | Module Size (W×H) | W320mm×H160mm |
| Cabinet | Cabinet Size (W×H×D) | 640mm×480mm×60mm (With Back Cover) |
| | Cabinet Weight (kg/panel) | 7.8 kg |
| | Maintenance | Full front maintenance |
| | Ingress Protection | IP30 |
| | Planeness | ≤0.5mm |
| | Cabinet Material | Die-casting Aluminum |
| Optical | Single-dot Brightness Calibration | Support |
| | Brightness | 600 cd/m ² |
| | Color Temperature | 2000K ~ 9300K Adjustable |
| | Beam Angle (Hor/Ver°) | 140°/140° |
| | Brightness/Color Uniformity | ≥98% |
| | Contrast Ratio | 5000:1 |
| Electroni | Input Power <Max> | 488 W/m ² |
| | Input Power <Typical> | 146 W/m ² |
| | Power Supply Input Voltage | AC200-240V, Frequency 47-63(Hz) |
| Performance | Frame Changing Frequency | 60Hz |
| | Refresh Rate | 3840Hz |
| | Processing Depth | 12~14Bit |
| | Video Support | 2K、4K |
| Environm | Life Span (hrs) | 100000hrs |
| | Working Temp/Humidity (°C/RH) | -20°C~45°C / 10%~60%RH (No Condensation) |
| | Storage Temp/Humidity (°C/RH) | -20°C~50°C / 10%~65%RH (No Condensation) |
| | Certification | CE/CB/ROHS/EAC/CCC/BS476-7 |

Note:

- Product pictures are for illustration only, the actual product effects (including but not limited to appearance, color, size) may be slightly different, please refer to the actual product.
- The specification parameters are reference values. Part of the data comes from Unilumin's internal laboratory and is obtained under a specific test environment. In actual use, it may be slightly different due to product batch differences, configuration differences, software versions, use conditions and environmental factors. Actual usage shall prevail.
- Different configurations can achieve different refresh rates.